

# A COMPREHENSIVE PICTURE BOOK OF THE CABIN



Company contact : Shirley      Contact number : +86-13512762486

**Guangdong Guose Building Technology Group Co., LTD**

Guangzhou Office Address : Room 311, Huayue Building, 423 Xicha Road, Baiyun District, Guangzhou City, Guangdong Province

Factory address : No. 21, Linjiang Avenue, Yong'an Industrial Park, Dinghu District, Zhaoqing City, Guangdong Province



Website:  
[www.steelmarkhouse.com](http://www.steelmarkhouse.com)  
[www.guosegroup.com](http://www.guosegroup.com)

INS



## COMPANY PROFILE

Guangdong Guose Building Technology Group Co., Ltd is located in Guangzhou City, Guangdong Province. It is a professional steel structure company with trading branches in Australia and Zhaoqing, China. The factory covers an area of 60,000 square meters and has an outdoor exhibition hall of 30,000 square meters. The products are exported to all over the world.

For more than two decades, we have provided OEM services to many international brands in the field of residential construction. Today, Guose has the most complete product series of space capsules, apple cabins, light steel housing products, containers and other product series, including light steel villas, light steel B&Bs, light steel commercial buildings, gas stations, space capsules, apples, etc. cabins, house-boats, container homes, container offices, container restaurants, etc.

All Guose products have obtained ISO certification. Each product will undergo detailed inspection and quality verification before delivery to ensure that the product structure and appearance are intact, and will be packaged to ensure that the product is not damaged during transportation. Our technology is mature, our annual output value reaches hundreds of millions, our prices are competitive, and we have established many high-profile cases in Australia, the United States, the Philippines, Israel, Nigeria and Japan.



# Guose T6

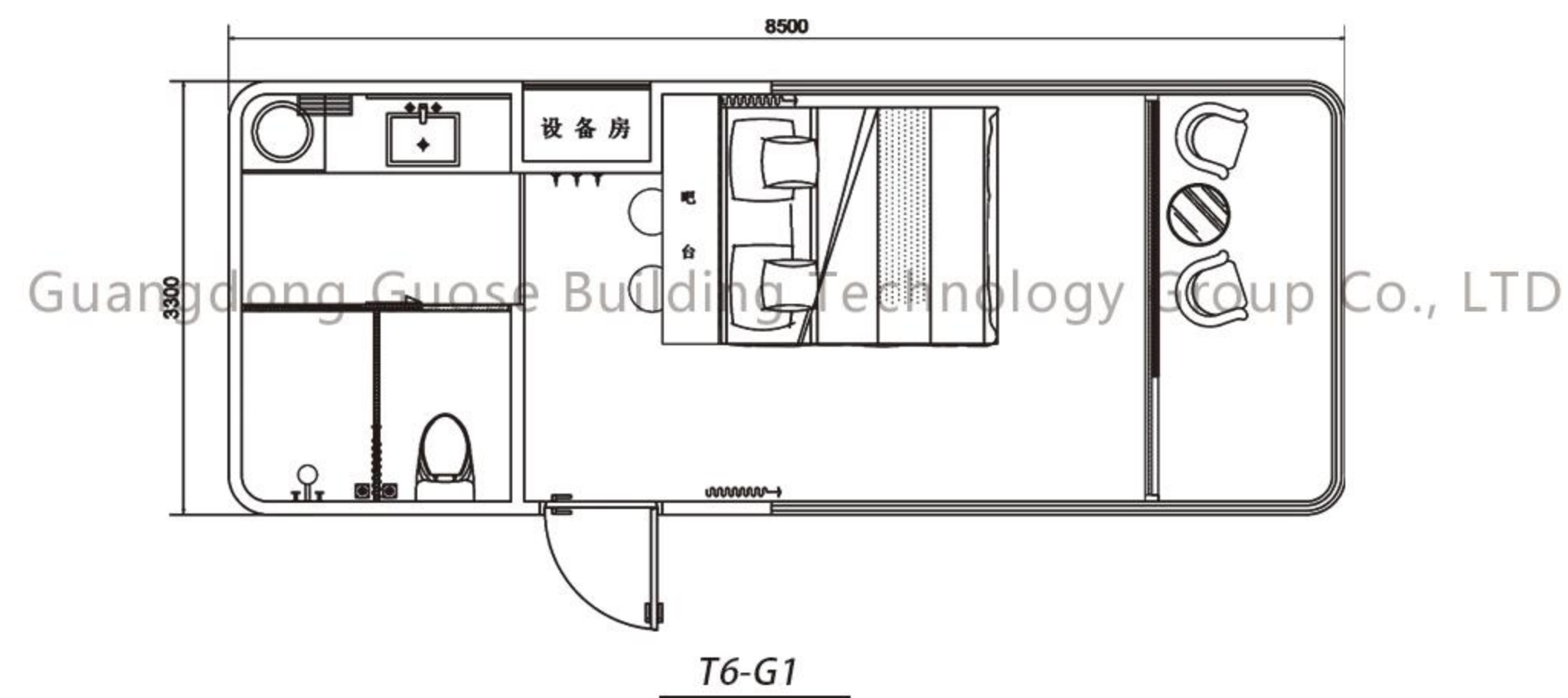

## PRODUCT PARAMETERS

Size: 8500\*3300\*3300mm, building area: 28.05m<sup>2</sup>

Number of occupancy: 4-6 people

Maximum power consumption: 12KW

Indoor floor load: 500KG/m<sup>2</sup>

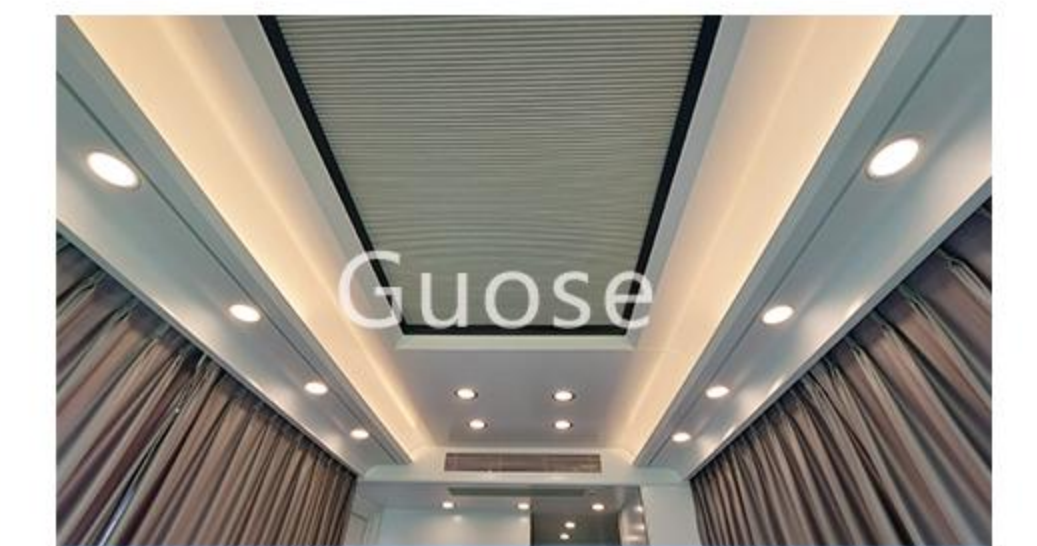



# Guose T6

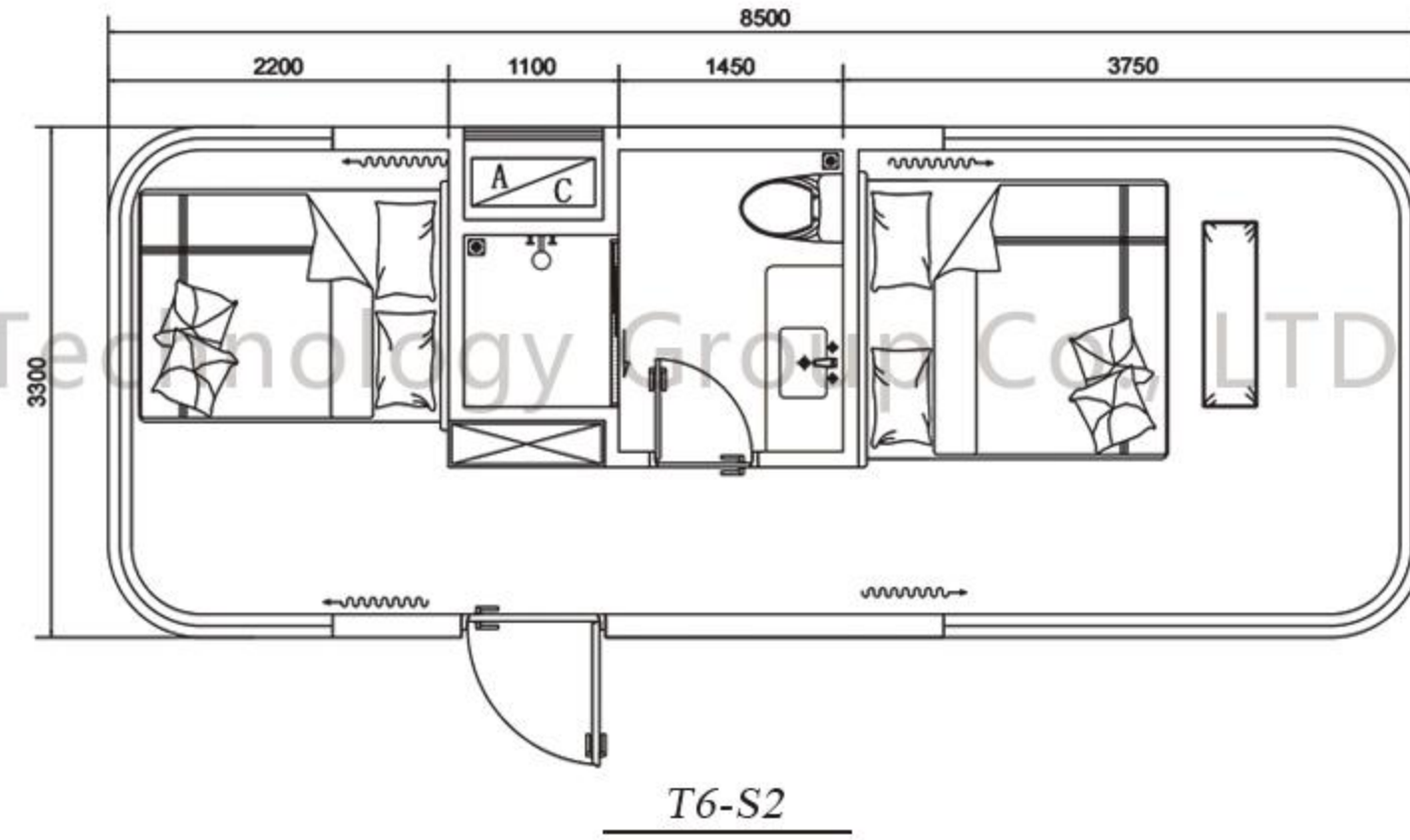
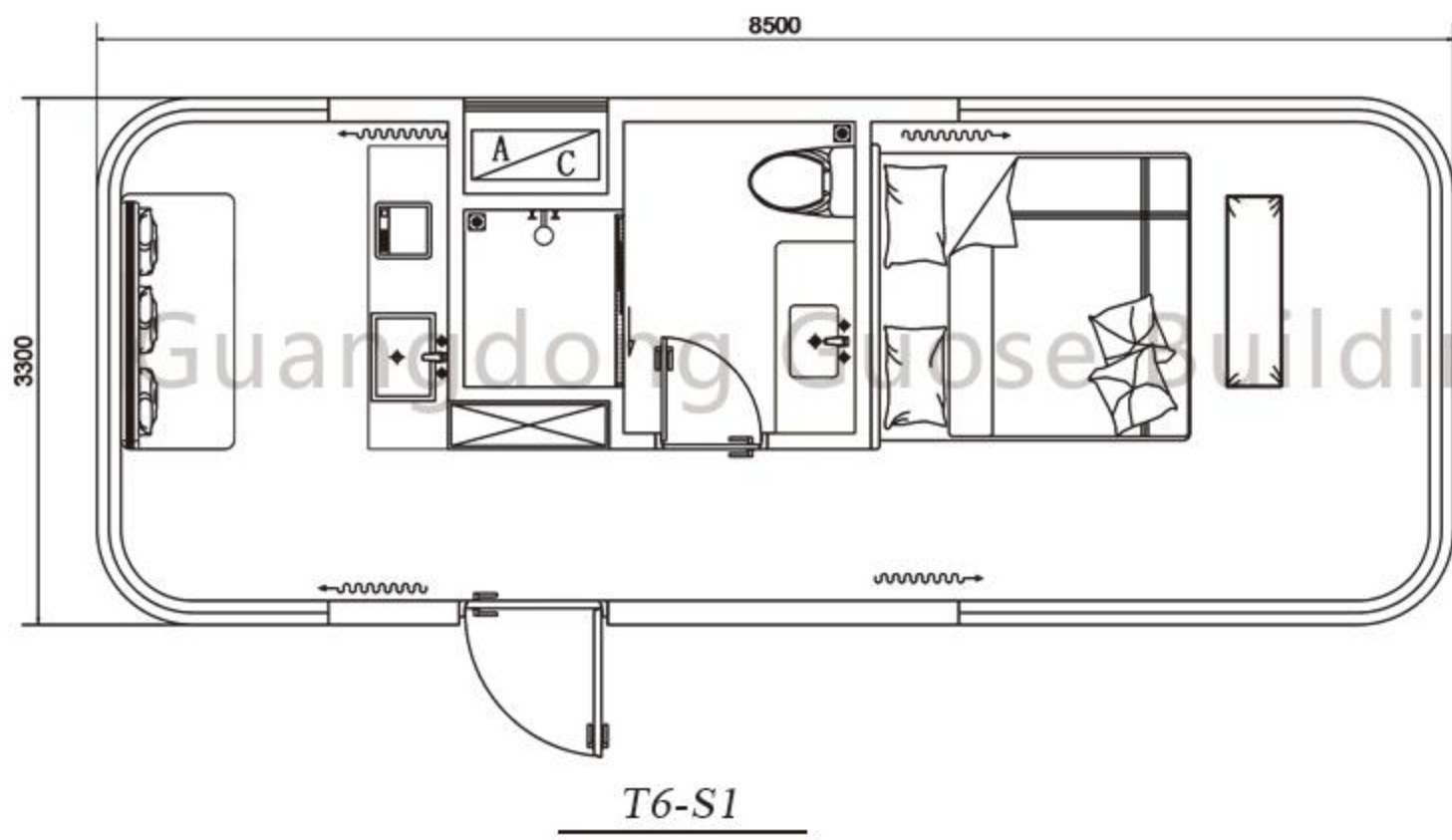

## PRODUCT PARAMETERS

Size: 8500\*3300\*3300mm

Number of people staying: 4-6 people

Indoor floor load: 500KG/m<sup>2</sup>

Building area: 28.05m<sup>2</sup>

Maximum power consumption: 12KW



# Guose T8

## PRODUCT PARAMETERS

Size: 11500\*3300\*3300mm

Building area: 37.95m<sup>2</sup>

Maximum power consumption: 12KW

Number of occupancy: 4-6 people

Indoor ground load: 500KG/m<sup>2</sup>

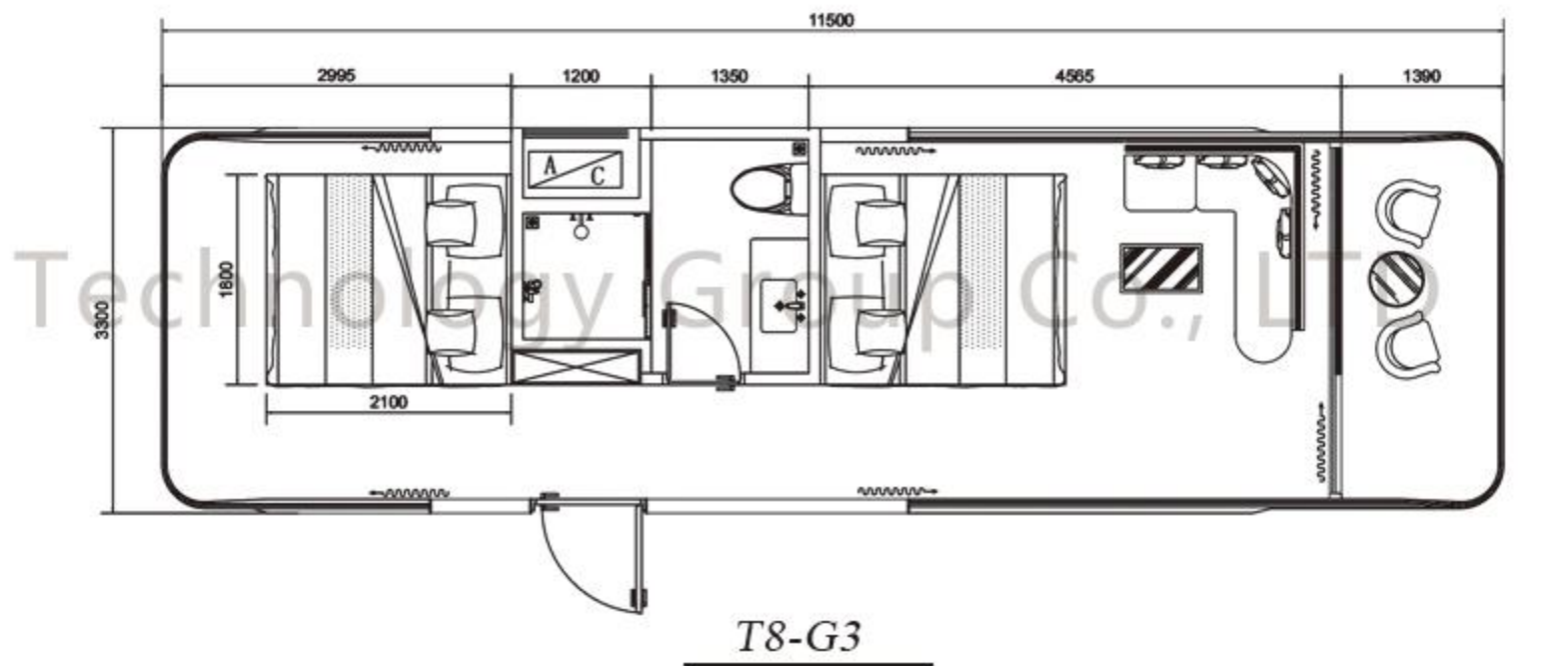
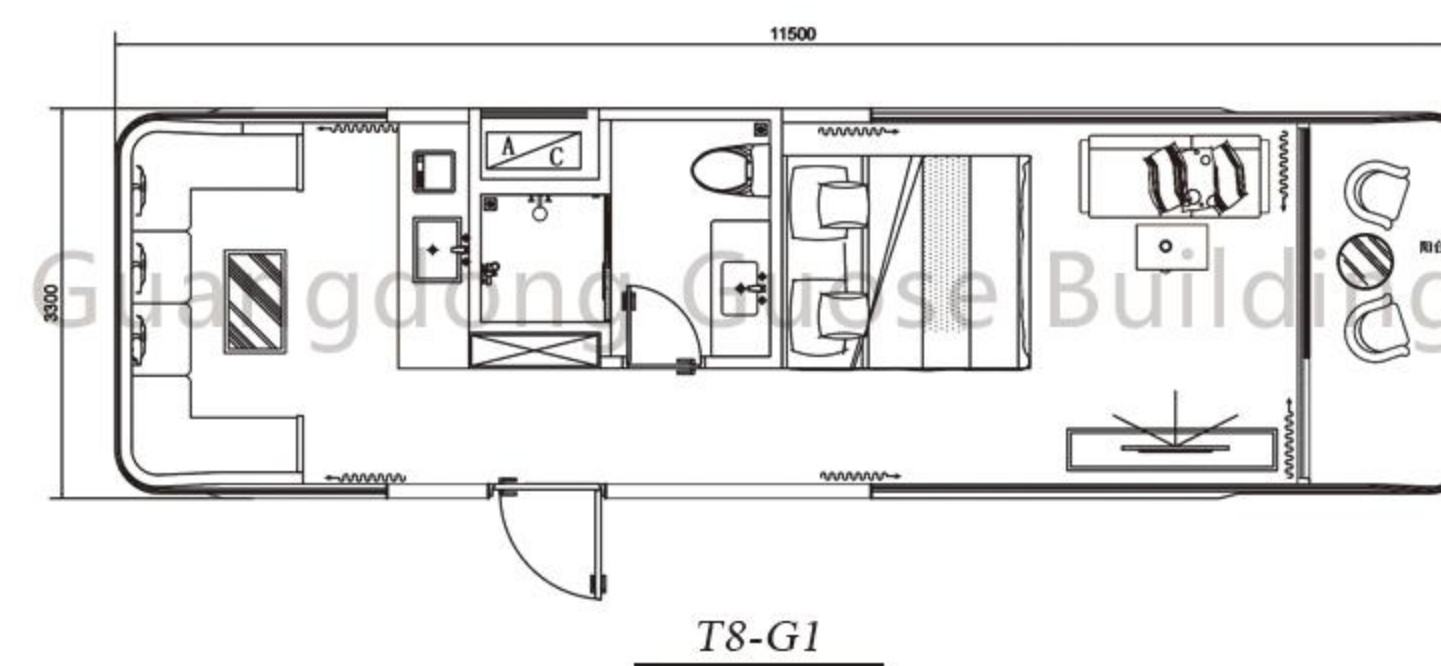

Guangdong Guose Building Technology Group Co., Ltd.

# Guose T8

## PRODUCT PARAMETERS

Size: 11500\*3300\*3300mm

Building area: 37.95m<sup>2</sup>

Maximum power consumption: 12KW

Number of occupancy: 4-6 people

Indoor ground load: 500KG/m<sup>2</sup>

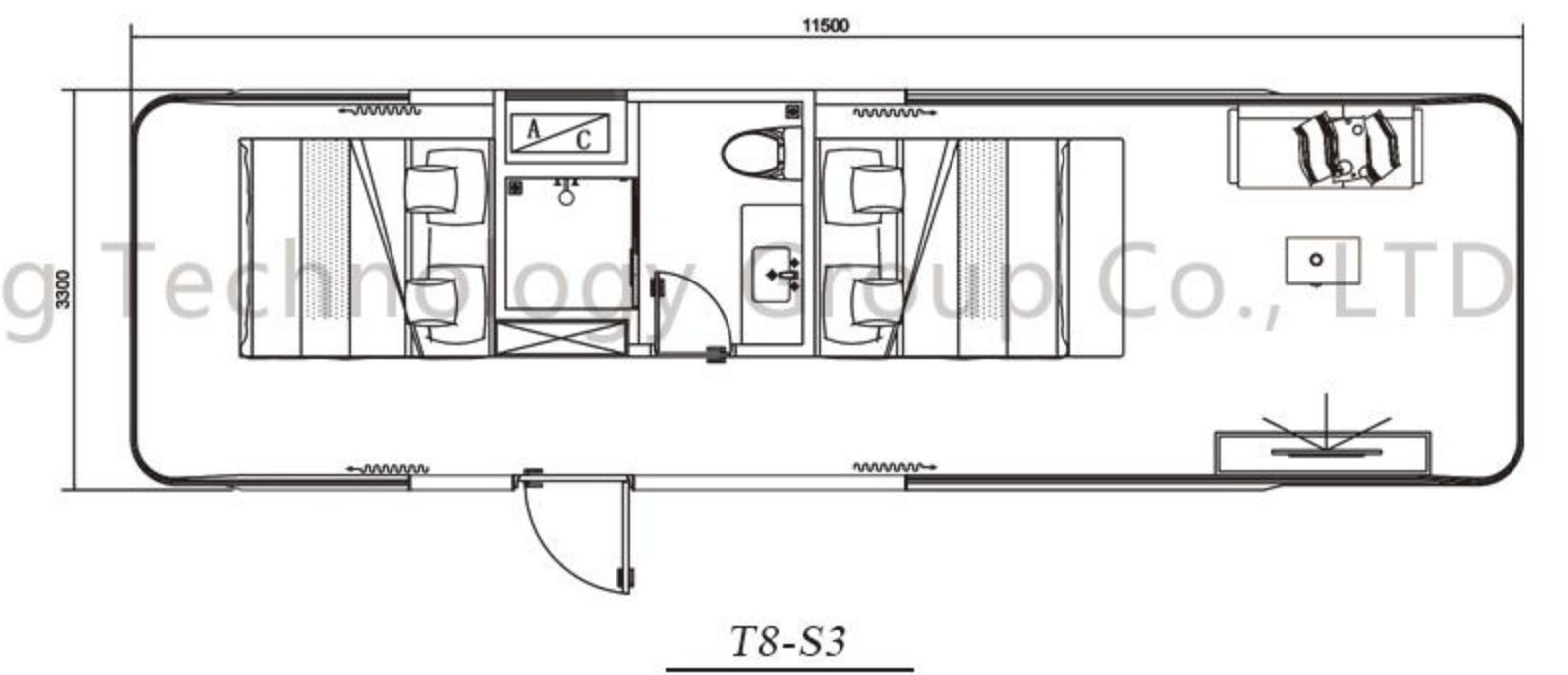
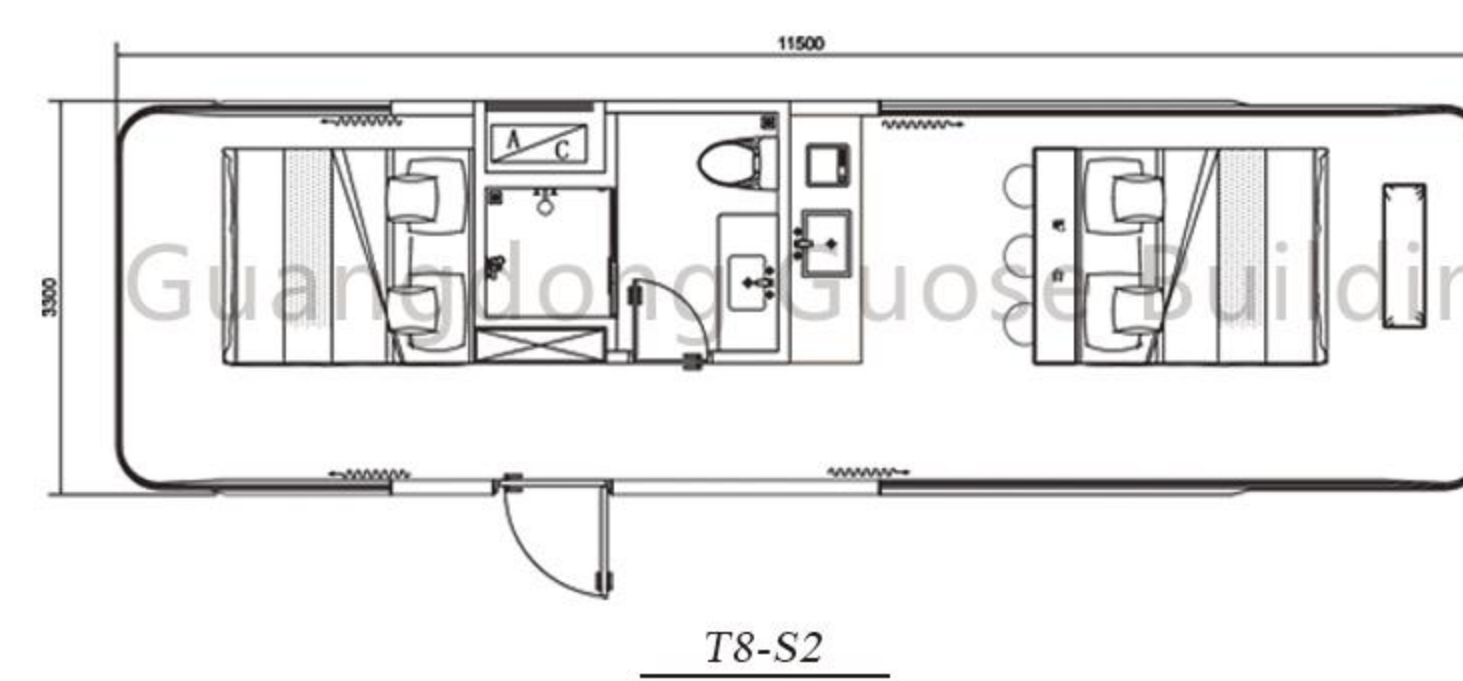

# GUOSE T9 (Fully equipped)



**PRODUCT PARAMETERS (FULLY EQUIPPED)**

Size: 11500\*3300\*3300mm  
 Building area: 37.95m<sup>2</sup>  
 Number of occupancy: 4-6 people  
 Maximum power consumption: 12KW  
 Indoor ground load: 500KG/m<sup>2</sup>

**PREFERRED FOR COLD AREAS**  
 With underfloor heating system, water pipe heating, integrated water heater

**INTELLIGENT CONTROL OF THE WHOLE HOUSE**  
 Infrared offline voice system, smart home

**A MUST FOR HIGH-END ACCOMMODATION**  
 Fresh air system, projection screen, sound

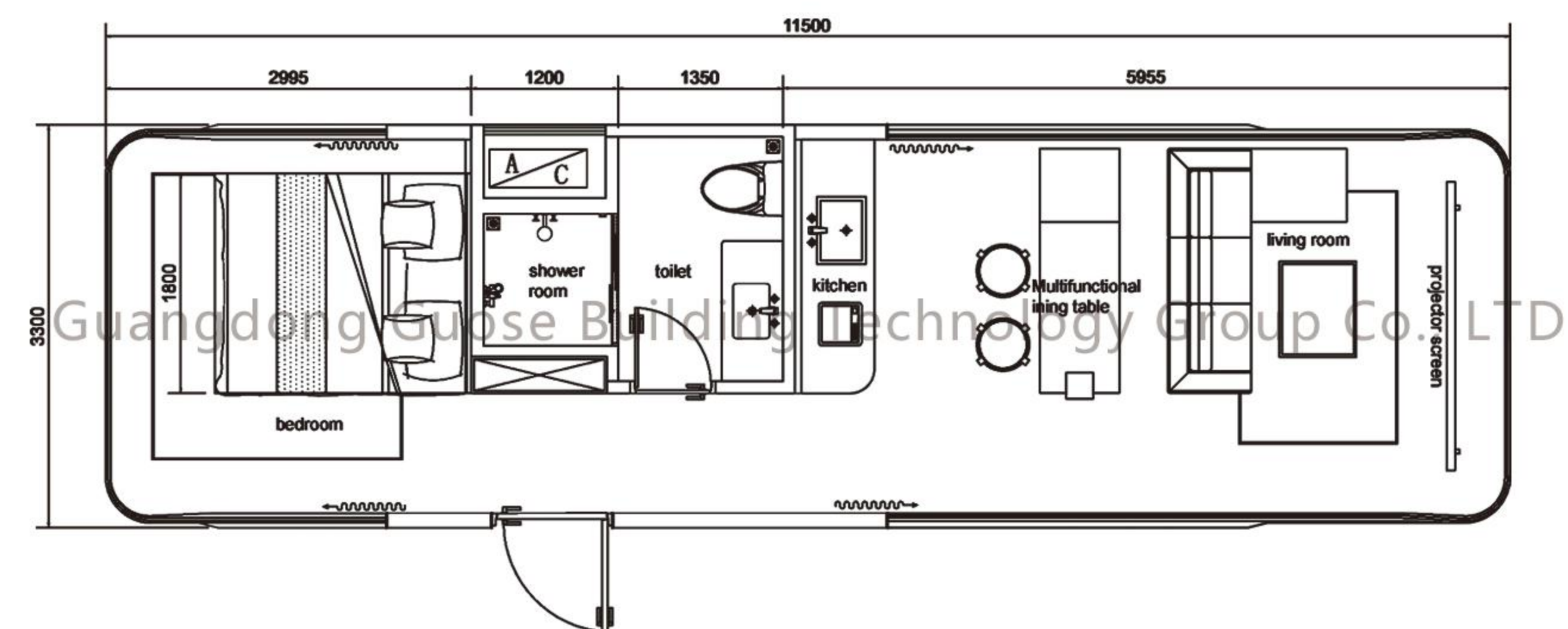

# GUOSE T9-1

(With second floor deck and terrace)



## PRODUCT PARAMETERS

- Cabin size: 11500mm(L)\*3300mm(W)\*3300mm(H)
- Second floor terrace size: 11500mm(L)\*3300mm(W)
- First floor balcony size: 10000mm(L)\*2000mm(W)\*3300mm(H)
- Building area: 57.95m<sup>2</sup>
- Number of occupancy: 2-4people
- Maximum power consumption: 12KW
- Indoor ground load: 500KG/m<sup>2</sup>

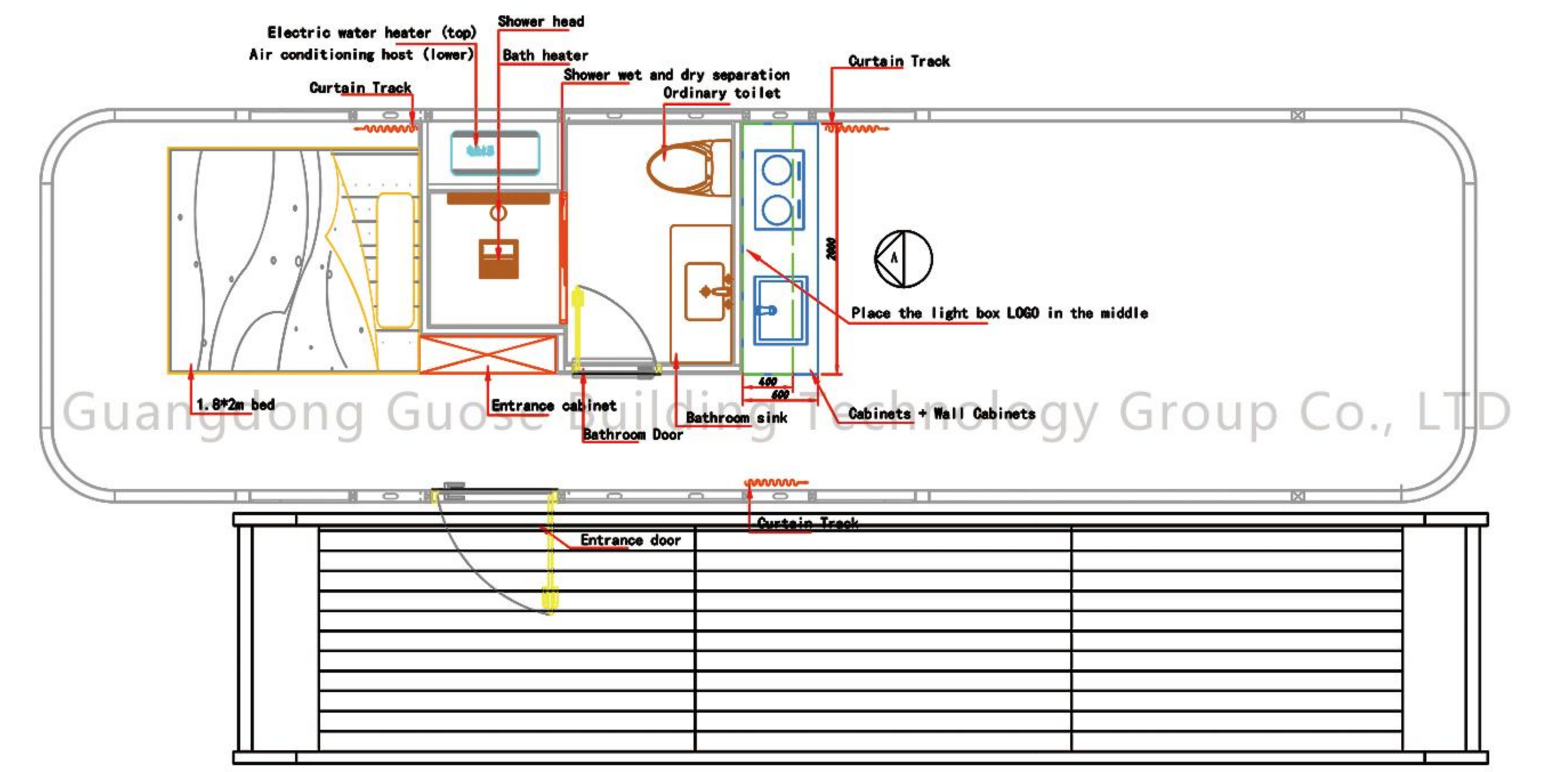



# GUOSE T10



## PRODUCT PARAMETERS

Size: 9600\*3300\*3200mm

Building area: 31.68m<sup>2</sup>

Number of occupancy: 4-6 people

Maximum power consumption: 12KW

Indoor ground load: 500KG/m<sup>2</sup>

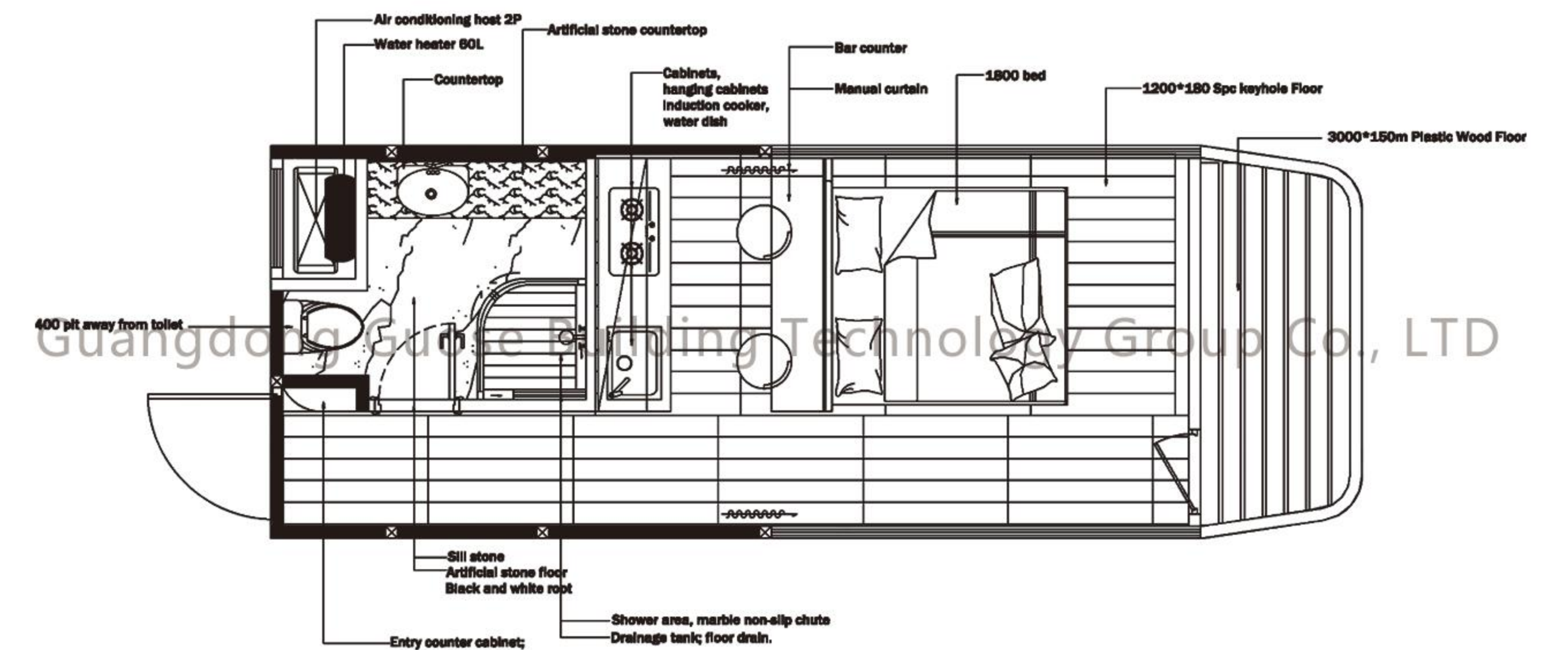

# MORE STYLES



## PRODUCT PARAMETERS

Cabin size: 5600mm(L)\*3300mm(W)\*3300mm(H)

Building area: 18.48m<sup>2</sup>

Number of occupancy: 2-4people

Maximum power consumption: 12KW

Indoor ground load: 500KG/m<sup>2</sup>

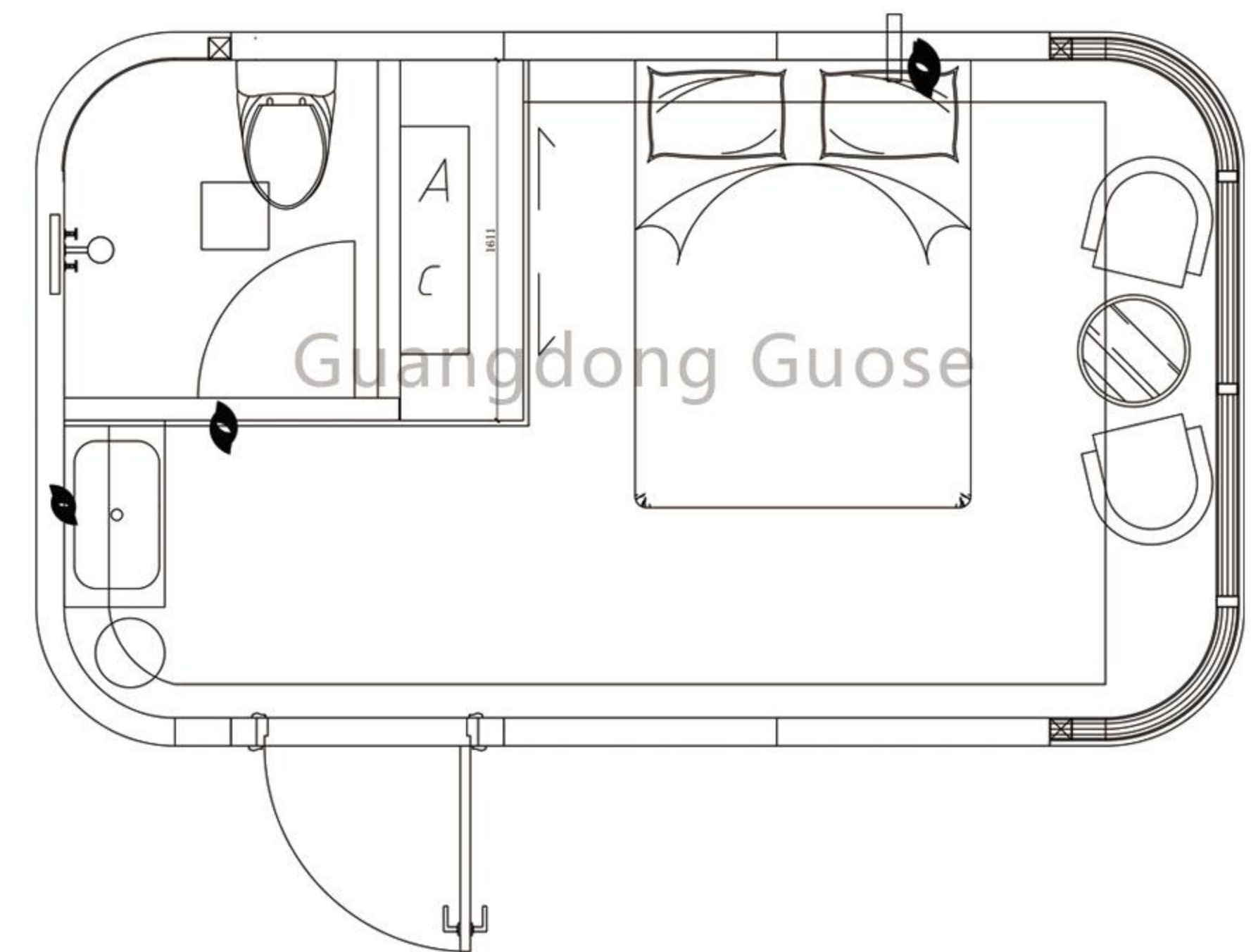

# CAPSULE HOUSE WITH SOLAR PANEL

**MORE  
STYLES**

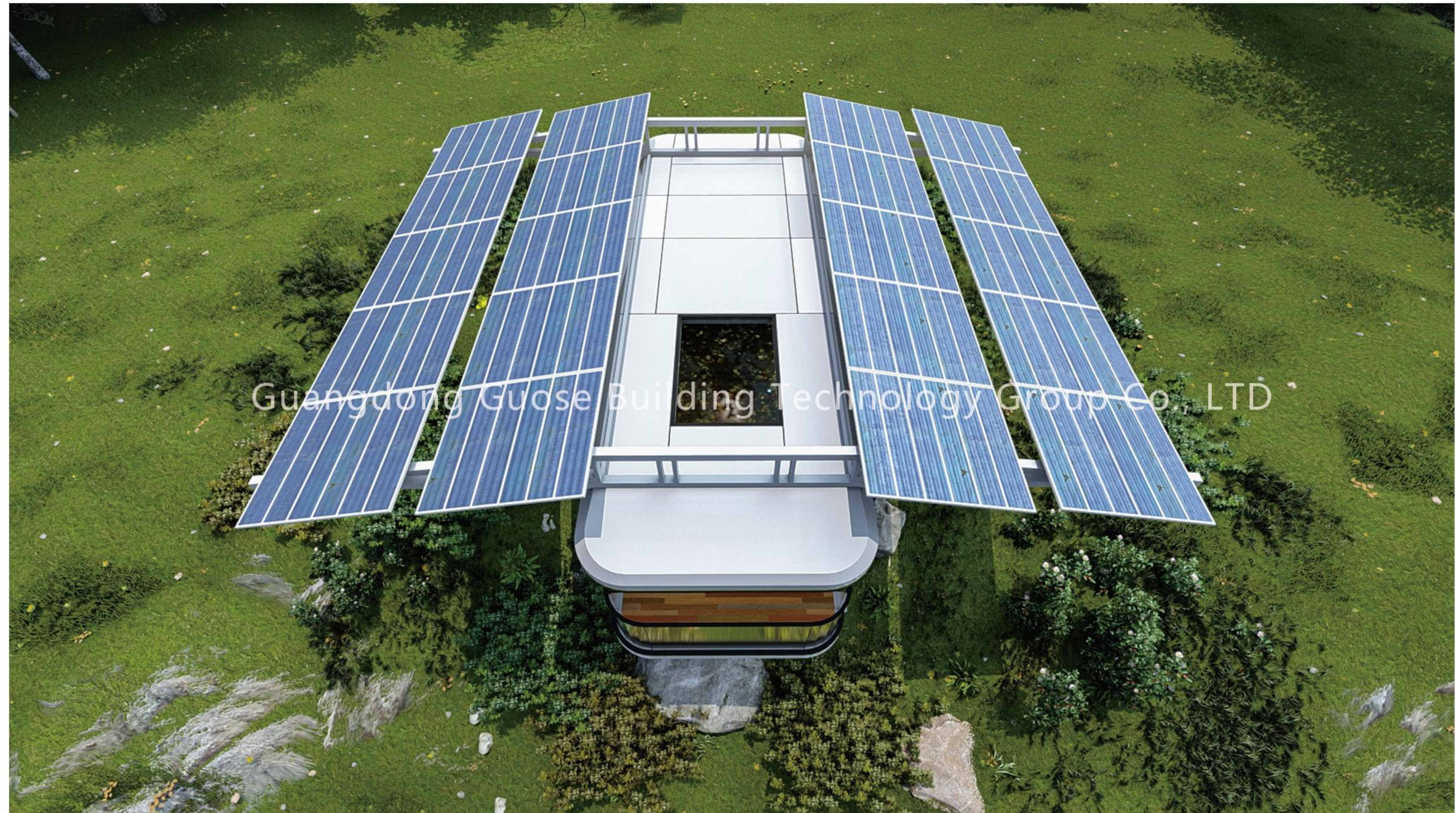

# MORE STYLES



**Guose T6**



**Guose T6**



**Guose T8**



**Guose T8**



# PROJECT CASES



SPACE CAPSULE NIGHT VIEW



# PROJECT CASES



## SHAANXI PROJECT

---





# PROJECT CASES



CAMP PROJECT

---





# PROJECT CASES



## XINJIANG PROJECT

---







# PROJECT CASES



## CONGHUA PROJECT IN GUANGZHOU





# PROJECT CASES



## GUANGDONG CAMP PROJECT





# PROJECT CASES



## AMERICAN CAMP PROJECT





# PROJECT CASES



## GUIZHOU PROJECT

---





# PROJECT CASES



## SAUDI ARABIA CAMP PROJECT





# PROJECT CASES



## PROJECTS IN POLAND

---





# TRANSPORTATION METHOD



## APPLE CABIN TRANSPORTATION METHOD

1. After the product is packaged, it is transported on a large flatbed or on a consignment truck.
2. After the products are packaged, they are transported in cabinets.

Strict safety protection measures will be adopted during the product's journey from the factory to the camp site. Ensure safety and stability during transportation.

## SPACE CAPSULE TRANSPORTATION METHOD

1. After the product is packaged, it is transported on a large flatbed or on a consignment truck.
- During the journey of the product from the factory to the camp site, strict safety protection measures will be adopted to ensure safety and stability during transportation.



FACTORY : No. 21, Linjiang Avenue, Yong'an Industrial Park, Dinghu District, Zhaoqing City, Guangdong Province  
GUANGZHOU OFFICE : Room 311, Huayue Building, 423 Xicha Road, Baiyun District, Guangzhou City, Guangdong Province